

### ADVANTAGES

- Rugged construction
- Inert at chemicals
- Interchangeability bag filters and cartridges High Flow WH
- 3 years warranty

### FEATURES

- PP solid monobloc body
- PP and PVDF versions
- Swing bolts closure system with swing bolts
- Til lid
- Lid inlet
- Union connection
- SIZE 1-2-4 bags availability
- Tmax exercise PP 85°C-PVDF 100°C
- Pmax exercise: 6 Bar @ 20°C

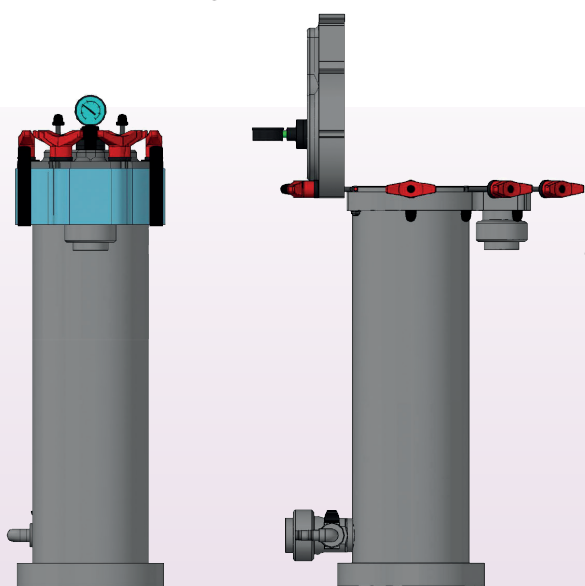

| TOP VERSION |                    |       |                |             |                     |   |
|-------------|--------------------|-------|----------------|-------------|---------------------|---|
| SERIES      | MATERIAL           | INLET | SIZE           | IN/OUT Ø mm | ATTACKS TYPE        | OPTIONAL  |
| CFB         | _ = PP<br>V = PVDF | T=TOP | 1040 = SIZE 4  | 25          | B=<br>SOCKET UNIONS | G=<br>Pressure gauge<br>R=<br>Splashproof lid Ring<br>I=<br>lid Interlock safety sensor |
|             |                    |       | 1840H = SIZE 1 | 32          |                     |   |
|             |                    |       | 1880H = SIZE 2 | 40          |                     |   |
|             |                    |       |                | 50          |                     |   |
| CFB         | T                  |       | 1880H          | 63          | B                   | GR  |

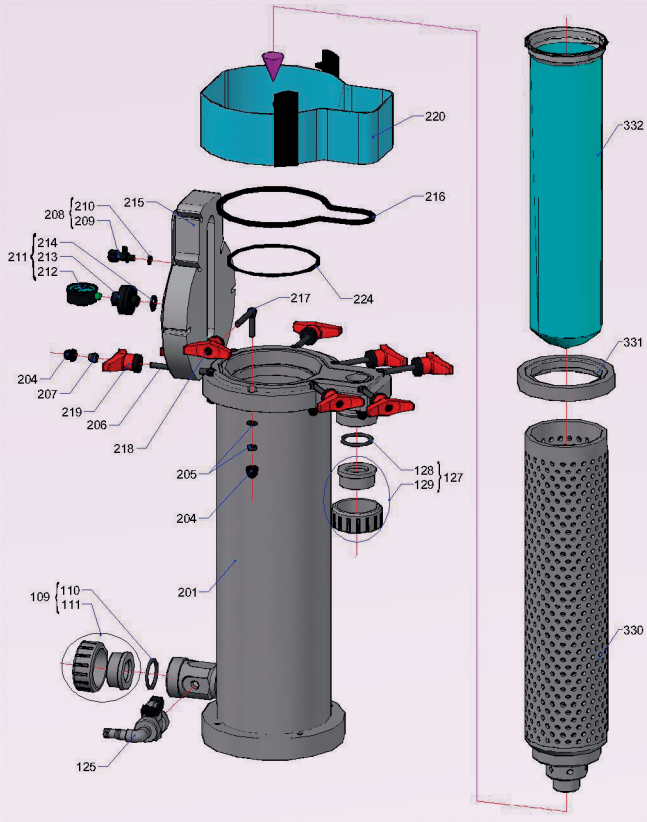

## DESCRIPTION

|     |                               |     |                           |
|-----|-------------------------------|-----|---------------------------|
| 109 | Discharge assembly            | 211 | Pressure gauge assembly   |
| 110 | O-Ring                        | 212 | Pressure gauge            |
| 111 | Discharge                     | 213 | Guard                     |
| 125 | Drain valve                   | 214 | O-Ring                    |
| 127 | Inlet filter-housing assembly | 215 | Lid                       |
| 128 | O-Ring                        | 216 | Lid gasket                |
| 129 | Connecting fitting            | 217 | Short swing bolts         |
| 201 | Filter body                   | 218 | Knob close two lobes      |
| 204 | PP nut cap                    | 219 | Knob open two lobes       |
| 205 | Nut & washer                  | 220 | Splash proof lid ring     |
| 206 | Long swing bolts              | 224 | O-ring cantering ring     |
| 207 | Blind nut                     | 330 | Basket filter bag         |
| 208 | Vent valve assembly           | 331 | Centering ring filter bag |
| 209 | Vent valve                    | 332 | Filter bag                |
| 210 | O-Ring                        |     |                           |

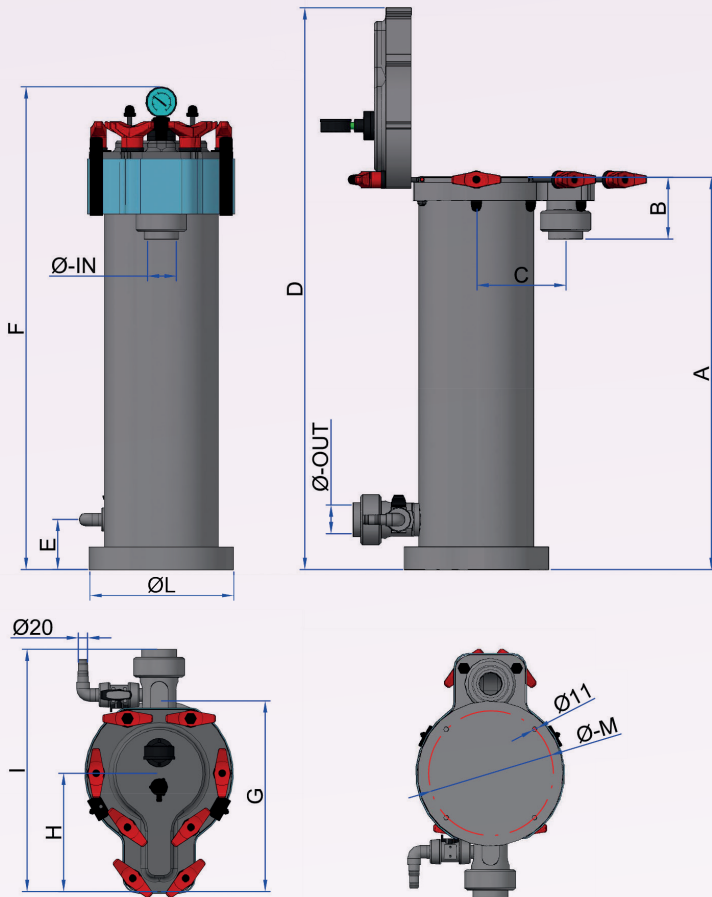

## BAG FILTER HOUSING

| Type  | 1040  | 1840 H | 1880 H |
|-------|-------|--------|--------|
| A     | 415   | 530    | 860    |
| B     | 83    | 136    | 136    |
| C     | 115   | 195    | 195    |
| D     | 630   | 917    | 1231   |
| E     | 70    | 110    | 110    |
| F     | 570   | 730    | 1060   |
| G     | 262   | 415    | 415    |
| H     | 152   | 257    | 257    |
| I     | 360   | 530    | 530    |
| Ø L   | 220   | 315    | 315    |
| Ø M   | 186   | 271    | 271    |
| Ø IN  | 25-32 | 50-63  | 50-63  |
| Ø OUT | 25-32 | 50-63  | 50-63  |

PVDF version: dimension could change. Require drawing at our technical office